

K177 ASSEMBLY AND FITTING INSTRUCTIONS

Kit Contains

- 1 x Set of Assembly Instructions
- 2 x Hex Keys (4mm and 5mm)
- 4 x Load Plates
- 4 x Capscrews, M8
- 16 x Washers (3 Types)
- 16 x Capscrews, M6 (2 Sizes)
- 24 x T-Slot Nuts (3 Types)

Items you may require that are not included:
Tape Measure
Step Ladder (for taller vehicles)

Important Notes:

Disregard sections 2 - 5 in the Crossbar Assembly Instructions and refer to these instead.

Maximum P-Bar Load Rating

65 kg

Maximum Ford Escape Load Rating

50 kg

When Fitted and loaded correctly

1. Parts Identification

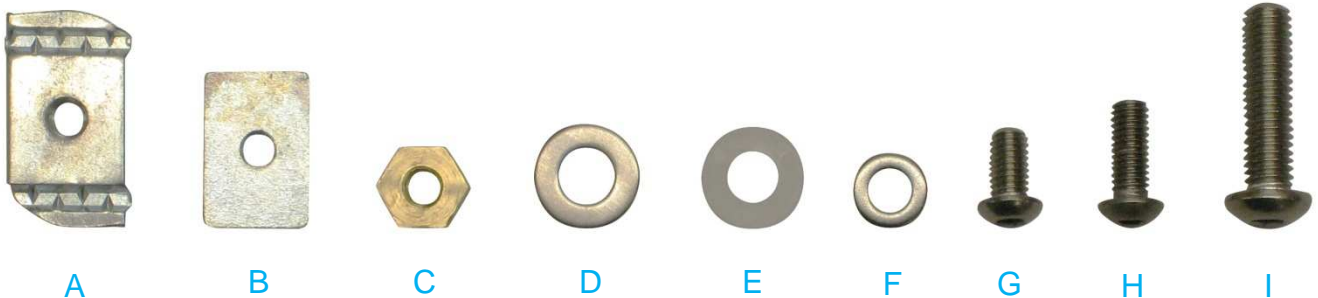

- A. T-Slot Nut, M6, 35 x 19 x 6mm
- B. T-Slot Nut, M6, 25 x 17 x 4mm
- C. T-Slot Nut, M6 Hex Nut, Brass
- D. Washer, M8
- E. Washer, M8, Plastic
- F. Washer, M6
- G. Capscrew, M6 x 12mm
- H. Capscrew, M6 x 16mm
- I. Capscrew, M8 x 30mm

Refer to the chart below to find out what parts required for fitting roof rack on your vehicle

Table 1

Vehicle	Year	T-Nut	Screws	Washers
Hilux Surf	95-02	A	G & I	D, E & F
Terrano/Regulus	96-03	B	G & I	D, E & F
Toyota Harrier	96-03	A	G & I	D, E & F
Commodore Wagon	97-08	C	H & I	D, E & F
Ford Escape	01+	B	G & I	D, E & F
Ford Focus Wagon	04-08	B	G & I	D, E, & F
Ford Galaxy MPV	06+	B	G & I	D, E, & F

2. Crossbar Legs and Load Plate Preparation

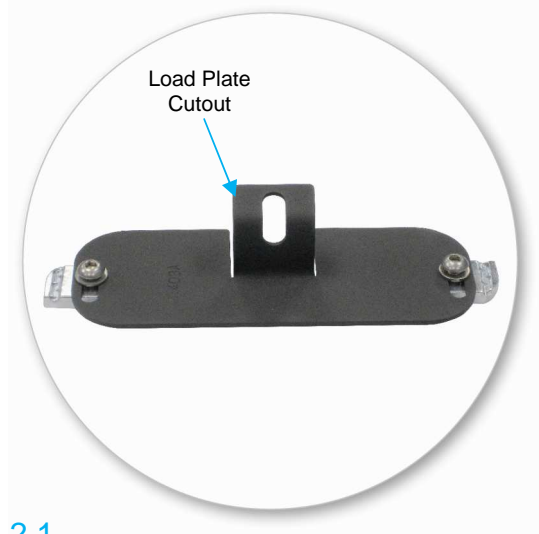
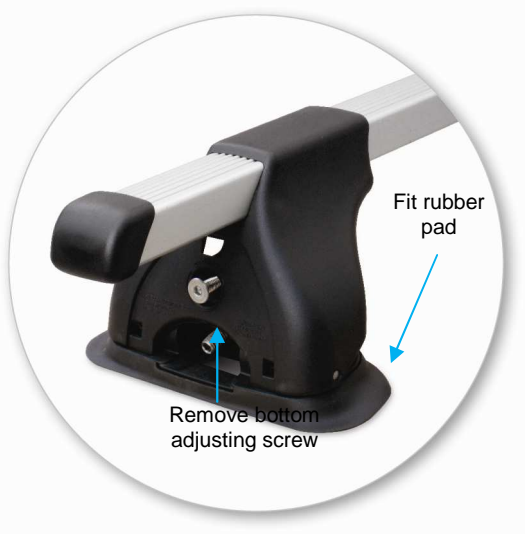

2.1

- Remove the bottom adjusting screw for selection of parts on each leg required for your vehicle
- Fit a rubber pad to the side as shown in the assembly 2 T-slot nuts on each side of the load plates using capscrews and washers
- There are two studs and washers location

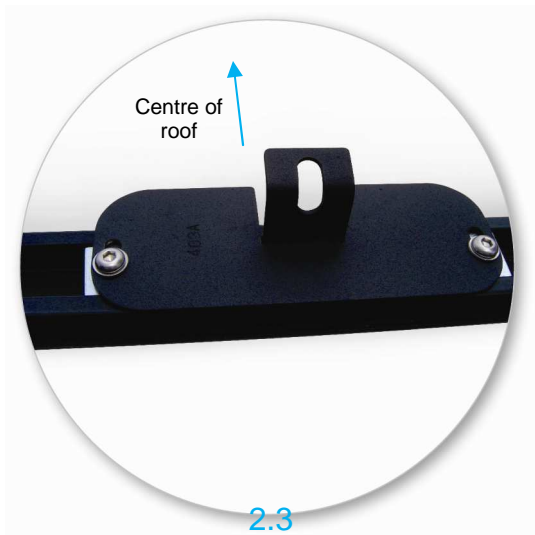

2.3

- Place load plates in mirrored positions on each track
- Spacing between load plate centers should be 700mm or more
- Ensure the load plates cut out face towards the center of the roof
- Begin to tighten capscrews
- Check that T-Slot nuts have engaged properly across the inside of track
- Type A nuts must have engraved circle facing down
- Fully tighten all 8 capscrews

3. Crossbar Fitment

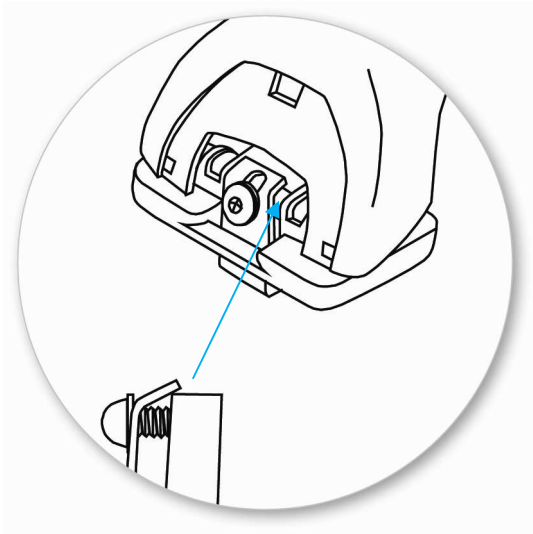

3.1

- Place crossbar assembly over the load plates
- The legs may need to be adjusted in or out, refer to Section 1 of Crossbar Instructions
- Hook load plate over the top edge of crossbar foot (see above)
- Onto cap screw (I) place washer (D) then washer (E)
- Begin to screw cap screws through the loadplate into the crossbar foot
- Make sure that the load plate tab is still hooked over the top edge of the foot



3.2

- Tighten bottom capscrew to 4Nm. Refer to Note 4B on the Crossbar Assembly Instructions
- Make sure that crossbars feel firm on vehicle tracks
- Check that crossbar rubber pads are sitting flat on load plates
- Tighten top locking screw to 4Nm
- Fit the four leg cover panels by hooking them in at top first then clipping them in at the sides.

Warning Notes

- Use these instruction in conjunction with crossbar instructions

WARNING: Check the Tightness of Screws Regularly